



# KLEEpump

## KSP series

KLEEpump KSP is a small, efficient, high-quality construction pump. Resistant to sand, mud and gravel. Can be supplied with bottom suction that can pump down to 3 mm. Available in 1- and 3-phase with or without automatic. Power from 0.4 to 0.75 kW.

The KLEEpump series is our own high-quality brand, and has been developed and tested in collaboration with our manufacturer.

See more at [www.klee.dk](http://www.klee.dk) for our selection of drain and sewage pumps.

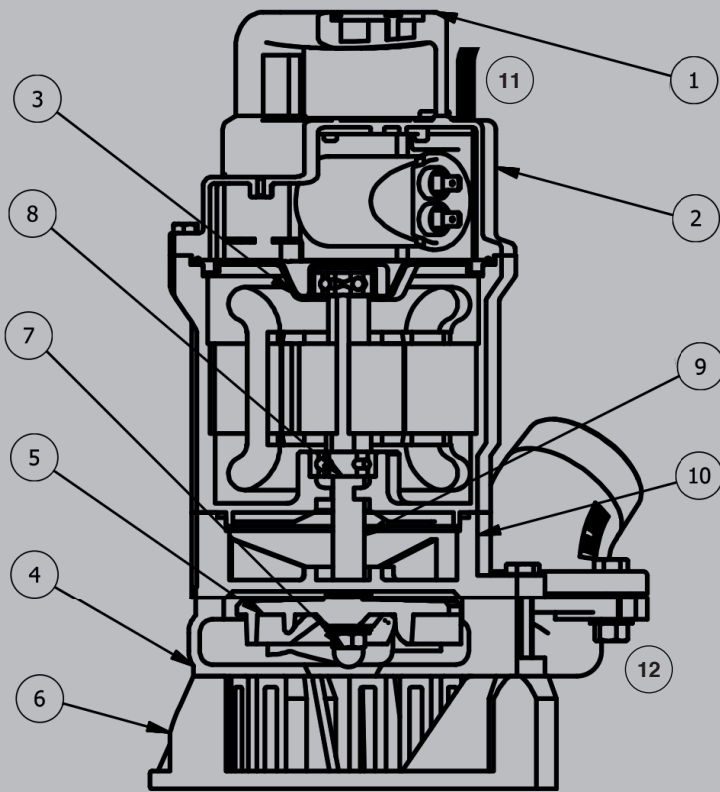

#### Component

1. Handle (Nylon)
2. Motor Cover
3. Fittings
4. Pump Casing (FC 200)
5. Impeller
6. Strainer
7. Agitator
8. Gasket (shaft seal) (SiC/SiC)
9. Shaft (SUS 410)
10. Motor Casing
11. Cable (H07RN-F)
12. Various screws & bolts (AISI 304)



#### Model codes

- KSP:** Name of series  
**S:** 1-phase (standard 1x230V)  
**T:** 3-phase (standard 3x400V)  
**SAL:** Vertical swimming switch  
**SA:** Swimming switch

#### Motor data (KSP)

- Motor power: 0,4-0,75 kW
- Frequency: 50Hz
- Nominal Speed: 2900 rpm
- Protection Device:  
Thermal Protector (1-phase)

#### Pump data (KSP)

- Impeller: Open Impeller
- Shaft Seal/Mechanical:  
Double Seals
- Bearing: Closed Ball Bearing

#### Operation Conditions

Fluid Temperature:  
0 to 40°C

#### Applications

- Construction need for drainage of surface water.
- Drainage with or without well (basements, residential areas, gardens).
- Waterfalls and fountains.
- Water from lakes and streams.
- Sludge Pumps in sumps.
- A pump for use in a pinch (low suction option).

#### Features

- Cables (10 m with Danish plug on 1-phase models)
- Impeller (Polyurethane suitable for sand and gravel)
- Switches (several types of automatics)
- Bottom strainer (can be replaced for a bottom suction with a working depth of 3 mm)
- Double mechanical SiC shaft seal (mounted in the oil chamber)
- Agitator (avoid clogging)
- Flanges and connections, etc.
- Pump houses

#### Accessories

- Hoses
- Storz couplings
- low suction



# KLEEpump - KSP series

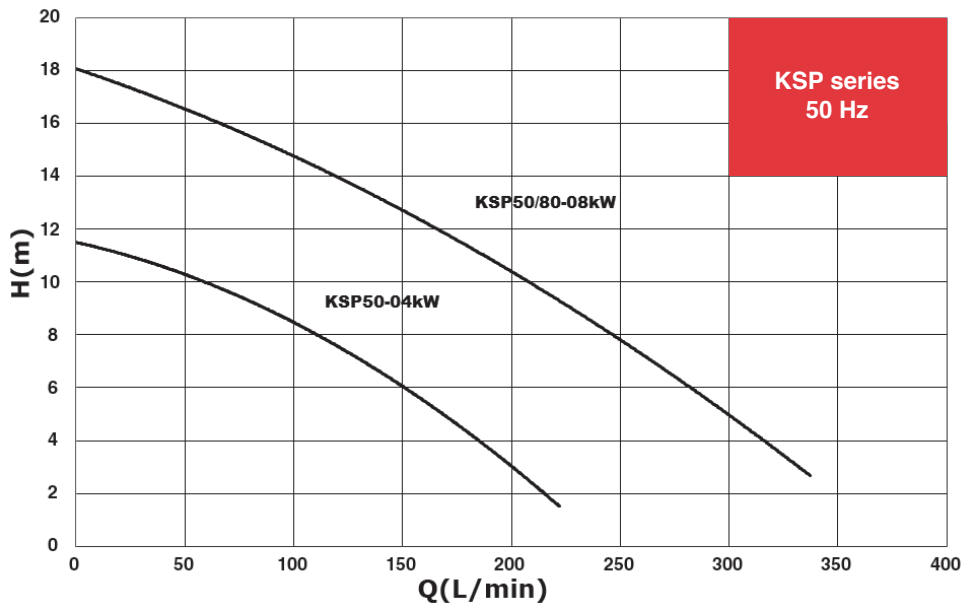

**KSP S/T**

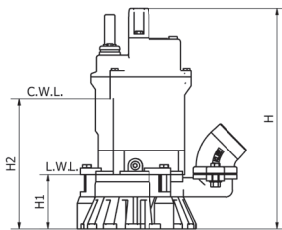

**KSP SA**

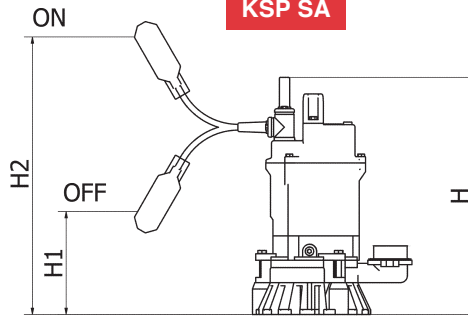

**KSP SAL**

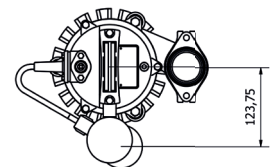
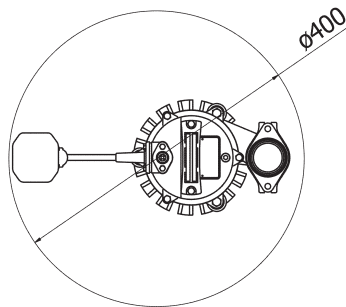
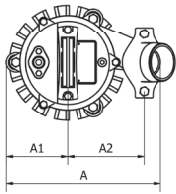
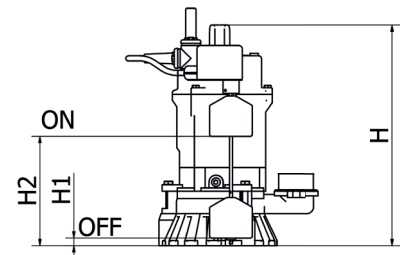

S= 1x230 (1-phase) / T= 3x400 (3-phase)

## Technical data

Discharge [mm]	Model	Version	Power kW	Current		Dimensions [mm]						Weight Kg
				Ø (Phase)	V	A	A1	A2	H	H1	H2	
50 (2")	KSP50-5-04-S/T	Manuel	0,4	1/3	1x230/3x400	249	95	120	343	90	200	12
	KSP50-5-04-SA	Automatik	0,4	1	230	249	95	120	343	200	400	12,3
	KSP50-5-04-SAL	Automatik	0,4	1	230	249	95	120	343	150	230	12,3
50/80 (2/3")	KSP50/80-5-08-S/T	Manuel	0,75	1/3	1x230/3x400	279	95	135	368	90	225	16
	KSP50/80-5-08-SA	Automatik	0,75	1	230	279	95	135	368	225	425	16,3
	KSP50/80-5-08-SAL	Automatik	0,75	1	230	279	95	135	368	175	255	16,3

All models are supplied with a hose connection except model 50-5-04-S which is supplied with a 45° bend.



See more at [www.klee.dk](http://www.klee.dk)

Retailer:

**Brd. Klee A/S**

Gadagervej 11  
2620 Albertslund  
Tel 43 86 83 33  
Fax 43 86 83 88  
[klee@klee.dk](mailto:klee@klee.dk)  
[www.klee.dk](http://www.klee.dk)